

USB A waterproof connector

Material

ABS/PBT/PA66 UL94V-0 1/8"
 6u"--50u"
 Connector Body: ABS/PBT/PA66 UL94V-0 1/8"
 Contact: Brass 4u"--20u" Gold Plated
 Sealing: EPDM
 RoHS CE

CGRUA - 20PFF P - SC8 - 001
 1 2 3 4 5 6 7 8 9 10

Specifications

DESCRIPTION	DETAILS	CODE
1 Connector Size	USB A Type	UA
2 Speed	2.0	20
3 Connector Type	Panel Front Mount	P
4 Connector Gender	Female	F
5 Contact Gender	Female	F
6 Assembly Style	PCB 180° or Solder	P/S
7 Mating Style	Screw	S
8 Backs hell	Circular	C
9 Waterproof Rating	IP68	8
10 Version	Without Flying Lead	001
	Whit Flying Lead	002



Front Panel Mount

Panel Thickness
 Max: 4.0 mm

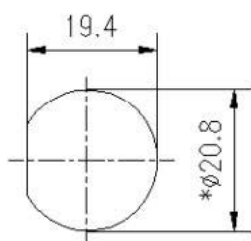

Panel Cut-Out

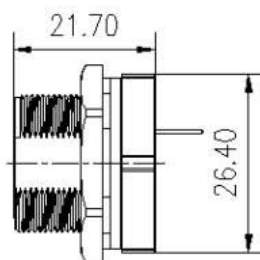

Version001

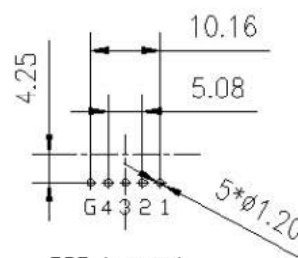

PCB Layout

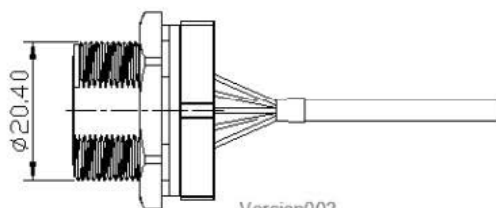

Version002

USB A waterproof connector

Material

ABS/PBT/PA66 UL94V-0 1/8"
 6u"--50u"
 Connector Body: ABS/PBT/PA66 UL94V-0 1/8"
 Contact: Brass 4u"--20u" Gold Plated
 Sealing: EPDM
 RoHS CE

CGRUA - 20PFF P - LC7 - 001
 1 2 3 4 5 6 7 8 9 10

Specifications

DESCRIPTION	DETAILS	CODE
1 Connector Size	USB A Type	UA
2 Speed	2.0	20
3 Connector Type	Panel Front Mount	P
4 Connector Gender	Female	F
5 Contact Gender	Female	F
6 Assembly Style	PCB 180° or Solder	P/S
7 Mating Style	Screw	S
8 Backs hell	Circular	C
9 Waterproof Rating	IP68	7
10 Version	Without Flying Lead	001
	Whit Flying Lead	002



Front Panel Mount

Panel Thickness
 Max:4.5 mm

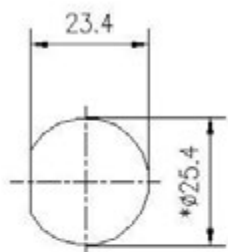

Panel Cut-Out

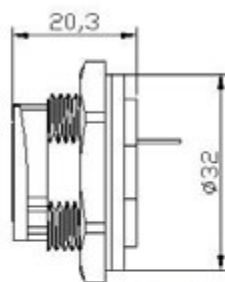

Version001

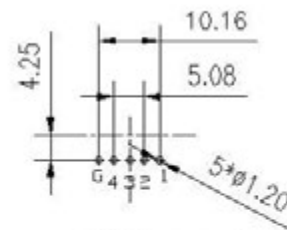

PCB Layout

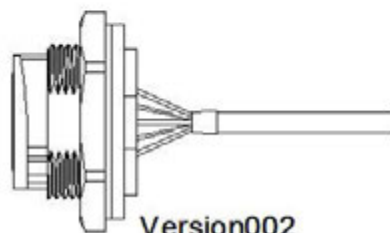
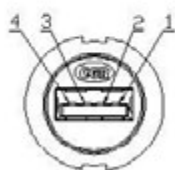

Version002

USB A waterproof connector with cap

Material

ABS/PBT/PA66 UL94V-0 1/8"
 6u"--50u"
 Connector Body: ABS/PBT/PA66 UL94V-0 1/8"
 Contact: Brass 4u"--20u" Gold Plated
 Sealing: EPDM
 RoHS CE

CGRUA - 20PFF P - LH7 - 001
 1 2 3 4 5 6 7 8 9 10

Specifications

DESCRIPTION	DETAILS	CODE
1 Connector Size	USB A Type	UA
2 Speed	2.0	20
3 Connector Type	Panel Front Mount	P
4 Connector Gender	Female	F
5 Contact Gender	Female	F
6 Assembly Style	PCB 180° or Solder	P/S
7 Mating Style	Lock	L
8 Backs hell	Rhombus	H
9 Waterproof Rating	IP67	7
10 Version	Without Flying Lead	001
	Whit Flying Lead	002



Real Panel Mount

Panel Thickness
 Max:3.0 mm

